

# Lavi X

Sports Wireless Earbud Headset  
運動無線藍牙耳掛式耳機



QUICK START GUIDE  
使用者手冊

Dear Valued Customer,  
In order to protect your consumer rights, please ensure that at the time of purchase you fill out the provided warranty certificate, coupled with the retailer stamp so as to ensure valid warranty.

親愛的顧客您好：為了保障您的權益，請您於購買時，立即請經銷商填寫購買日期並蓋店章，也請妥善保存保固書，才能享有本公司之完整售後服務。

|                           |         |          |           |          |
|---------------------------|---------|----------|-----------|----------|
| Product Name* (品名*)       |         |          |           |          |
| Serial number* (序號*)      |         |          |           |          |
| Date of purchase* (購買日期*) | AD (西元) | Year (年) | Month (月) | Date (日) |
| Name (姓名)                 |         |          |           |          |
| Telephone No. (電話)        |         |          |           |          |
| Address (地址)              |         |          |           |          |
| E-mail (電子信箱)             |         |          |           |          |

Store of purchase (Official stamp required) 經銷店章\* (請務必蓋章保固方為有效)

- Warranty period begins on the date of purchase of brand new, unused products by first-end user. Please retain receipt and warranty certificate as proof of purchase.
- If within warranty period, the product is determined defective, please return to the original store of purchase for a replacement.
- For additional services, please email [info@luxa2.com](mailto:info@luxa2.com) or contact one of our global offices, of which, details can be found on the previous page.
- 未蓋店章及未填上購買日期，則保固期限以產品序列號所查詢到的出貨日期開始計算。
- 送修流程：聯絡原購買店家→退回不良品→店家維修→返回顧客
- 如需其他服務，請寄電子郵件至 [info@luxa2.com](mailto:info@luxa2.com) 信箱或直接聯繫LUXA2全球分公司暨辦事處，詳情請洽LUXA2官網<http://www.luxa2.com/tw/>



©2009 Thermaltake Technology Co., Ltd. - LUXA2 Business Division

## Lavi X Sports Wireless Earbud Headset

Lavi X 運動無線藍牙耳掛式耳機

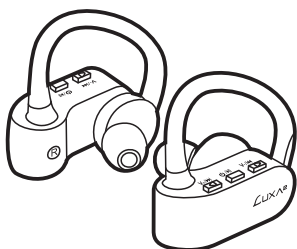

## Package Contents

包裝內容物

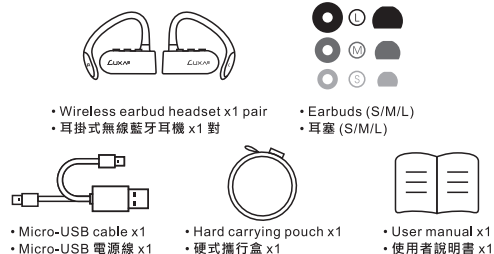

## Parts and Functions

部件及功能

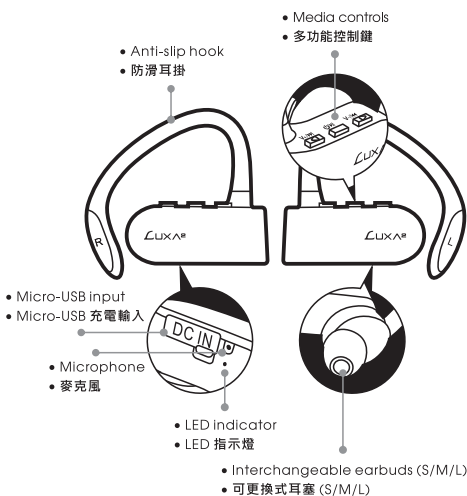

## LED Indicator

LED 指示燈

| Status        | Indicator              | 狀態  | 指示燈      |
|---------------|------------------------|-----|----------|
| Unpaired      | Blue (quick flash)     | 未配對 | 藍燈 (閃爍)  |
| Pairing       | Blue/Red (quick flash) | 配對  | 藍/紅 (閃爍) |
| Connected     | Blue (slow flash)      | 連接  | 藍燈 (慢閃)  |
| Low power     | Red (slow flash)       | 低電力 | 紅燈 (慢閃)  |
| Charging      | Red (solid)            | 充電  | 紅燈 (恆亮)  |
| Fully charged | Blue (solid)           | 充滿電 | 藍燈 (恆亮)  |

## How to charge the headset

如何對耳機充電

- The headset contains a micro USB cable that is used to charge the device. This can be charged via the USB port on your computer or other compatible devices made for USB charging.
- 耳機使用所附 Micro USB 充電線，可使用於有提供 USB 充電功能之接口，例如：筆記型電腦、桌上型電腦、行動電源或 USB 充電器。

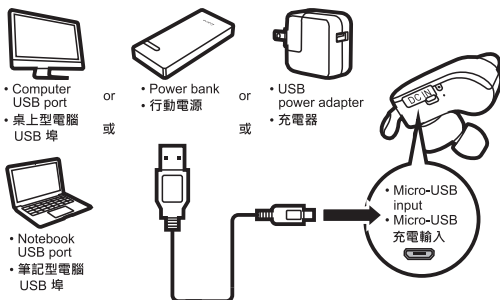

## Charging the Headset

對耳機充電

- Simply insert the micro USB cable into the corresponding port of the headset and plug the other end into the USB port of your USB charging compatible device and turn on. The LED indicator light on the headset will turn red (stable) whilst charging, and will automatically turn blue (solid) when fully charged.

- 將 Micro USB 電線插入耳機的另一端，插入 USB 端口充電相容設備，即可開始充電。當耳機 LED 指示燈亮紅燈，表示正在充電；轉為藍燈即充電完成。

| Status        | Indicator    | 狀態   | 指示燈     |
|---------------|--------------|------|---------|
| Charging      | Red (solid)  | 充電中  | 紅燈 (恆亮) |
| Fully charged | Blue (solid) | 充電完成 | 藍燈 (恆亮) |

- Charge time from flat (0-100%) is approximately 1 hr and can provide up to 6 hours of playing time via the headset.

- 充電時間約為 1 小時，即可連續播放音樂最多可達 6 小時。

| Status        | Time       | 狀態   | 時間       |
|---------------|------------|------|----------|
| Charging time | 1hr        | 充電時間 | 1 小時     |
| Playing time  | Up to 6hrs | 播放時間 | 最多到 6 小時 |

## Pairing- First time pairing (Single Mode) 第一次配對 (單隻模式)

### First time pairing

1. Press and hold the power button for about 7 seconds to activate Bluetooth searching mode. The LED indicator will start to flash blue and red rapidly.

### 第一次配對

1. 請長按電源鍵約 7 秒進行藍牙搜尋模式。LED 指示燈出現藍/紅交替閃爍。

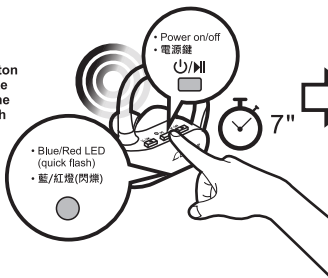

### Note:

- The headset can be paired with multiple devices, but can only play music from one paired device at a time
- Once Bluetooth devices are paired, there is no need to pair them again, except in the following cases:
  - Pairing information has been deleted
  - The headset is already paired with the maximum allowed devices

### 備註:

- 耳機可以跟多個設備配對，但是只能在一個設備上同時撥放音樂。
- 若是發生以下狀況，藍牙裝置就需要重新配對：
  - 配對訊息被刪除
  - 該耳機已配對超出允許的設備數

2. Activate the Bluetooth feature of your compatible device and search for Bluetooth devices.

2. 啟動你的藍牙裝置和開啟藍牙搜尋功能，去搜尋藍牙設備。

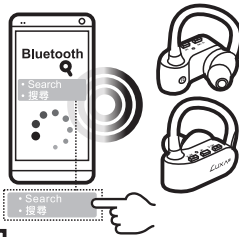

3. Select 'LUXA2 Lavi X' from the list of found devices and select to connect.

3. 在你的搜尋裝置中找到 'LUXA2 Lavi X' 並選擇 'LUXA2 Lavi X' 連接。



4. Once successfully paired, the LED indicator will return to a slow flashing blue status.

4. 成功配對後，LED 指示燈將會出現藍燈慢閃的狀態。

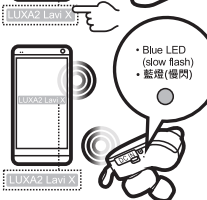

### Note:

After successful first-time pairing, your compatible device will automatically detect the earphone device when it is turned on thereafter.

### 備註:

當第一次成功配對後，以後當你開啟 Lavi X 耳機後，自動會與你的藍牙裝置配對。

## Dual Mode Pairing (Factory Default) 雙耳模式配對(工廠設置)

- Press and hold power button on either the L + R headset for around 7 seconds until quick flashing blue/red indicator is activated
- Activate Bluetooth on your device and pair with the 'LAVI X' device to pair
- Press and hold the power button on the other headset for around 2 seconds until blue LED indicator activates and wait 2-3 seconds for automatic pairing of both L + R headsets.

- 無論是左耳機或右耳機，長按電源鍵(約 7 秒)，直到 LED 指示燈變成藍/紅燈閃爍。
- 打開你的藍牙裝置並配對 Lavi X 耳機
- 按另一隻耳機電源鍵約兩秒啟動，LED 指示燈藍燈閃爍，約 2-3 秒鐘後，左右兩隻耳機自動配對。

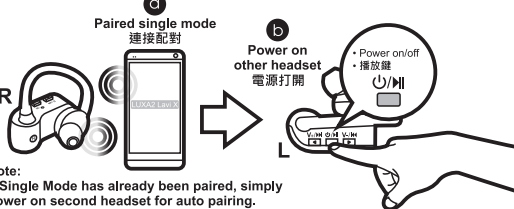

### Note:

If Single Mode has already been paired, simply power on second headset for auto pairing.

### 備註:

如果其中單隻模式耳機已經配對過，只要與第二隻耳機自動配對即可。

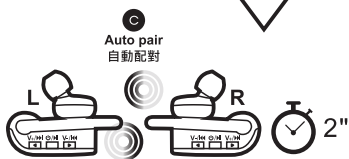

## Power Off 關機

- To power off the headset, press and hold the play button for approximately 3 seconds. The LED indicator will turn red (solid) as confirmation.

Note: If Dual Mode has been selected, powering off one headset will automatically turn the other headset off aswell.

- 當您想要關機時，只要按住電源鍵約 3 秒，LED 指示燈亮紅燈並熄滅，即為關機。

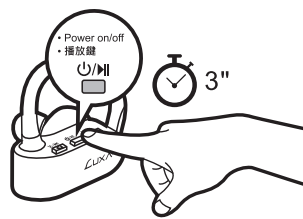

- 備註：如果是在雙隻耳機模式使用，只要關掉其中一隻耳機，即為自動同步關掉另一隻耳機。

## Calls 接電話

- To receive an incoming call once the headset is connected, press the play button. To end a call, again press the play button.

- 當有電話來時，只要按播放鍵就能接聽電話，要掛電話再按一次播放鍵即可。

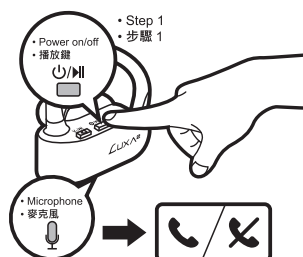

- Step 2 步驟 2

## Dual Mode Pairing (Reset) 雙耳模式(重新配對)

- Power on both L + R headsets at the same time
- Press and hold on both L + R headsets at the same time for about 7 seconds until quick flashing blue/red LED indicators activate
- L + R headsets will automatically detect and pair after a few seconds, confirmed by a synced slow Blue LED flash on both headsets
- Press and hold the power button on either the L or R headset for 3-4 seconds until power off.
- Follow Default dual pairing mode instructions

- 分別按下左右兩耳機的電源鍵，LED 指示燈轉為藍燈閃爍。
- 分別按下左右兩耳機 約 7 秒，直到兩耳機 LED 指示燈轉為藍/紅燈閃爍。
- 按住左右耳機其中一隻的電源鍵約 3-4 秒，直到 LED 指示燈轉為紅燈後熄滅，即為關機。
- 再做一次雙隻耳機模式開機步驟

## English

### Specifications

|                |                                                                                                                                                                                        |
|----------------|----------------------------------------------------------------------------------------------------------------------------------------------------------------------------------------|
| Battery type   | 95mAh lithium-polymer                                                                                                                                                                  |
| Charging time  | 1-2 hrs                                                                                                                                                                                |
| Driver         | Ø14.2mm /32 Ohms                                                                                                                                                                       |
| Bluetooth      | CSR v4.2 64210                                                                                                                                                                         |
| Wireless range | 10m                                                                                                                                                                                    |
| Playtime       | Up to 6hrs                                                                                                                                                                             |
| LED indicator  | Unpaired: Blue (quick flash)<br>Pairing: Blue/Red (quick flash)<br>Connected: Blue (slow flash)<br>Low power: Red (slow flash)<br>Charging: Red (solid)<br>Fully charged: Blue (solid) |
| Others         | Profile: A2DP, AVRCP, HSP, HFP<br>Frequency: 2402MHz-2480MHz<br>Frequency response: 20Hz~20KHz<br>Sound press level: 104dB±3dB<br>Microphone: Φ4.0*1.5mm, -42±3dB                      |
| Dimensions     | 48 x 40 x 32mm                                                                                                                                                                         |
| Weight         | 12g *2pcs                                                                                                                                                                              |

### ⚠ Warnings:

- Don't drop, disassemble or attempt to repair the earphone by yourself.
- Avoid exposure to water or high humidity.
- Don't expose to any heat source.

## 繁體中文

### 規格

|         |                                                                                                                         |
|---------|-------------------------------------------------------------------------------------------------------------------------|
| 電池類型    | 95mAh 鋰聚合物電池                                                                                                            |
| 充電時間    | 1-2 小時 (micro USB 輸入)                                                                                                   |
| Driver  | Ø14.2mm /32 Ohms                                                                                                        |
| 藍牙晶片模組  | CSR v4.2 64210                                                                                                          |
| 使用範圍    | 10m (開放空間)                                                                                                              |
| 連續播放效能  | 約六小時                                                                                                                    |
| LED 指示燈 | 藍牙未連接: 藍燈(快閃)<br>藍牙配對中: 藍燈與紅燈交替閃爍<br>藍牙連接成功: 藍燈(慢閃)<br>電量不足: 紅燈(慢閃)<br>充電中: 紅燈(恆亮)<br>充電完成: 藍燈(恆亮)                      |
| 其他      | 支援規格: A2DP, AVRCP, HSP, HFP<br>支援規格: 2402MHz-2480MHz<br>頻率響應: 20Hz~20KHz<br>聲壓等級: 104dB±3dB<br>麥克風: Φ4.0*1.5mm, -42±3dB |
| 尺寸      | 48 x 40 x 32mm                                                                                                          |
| 重量      | 12g *2 隻                                                                                                                |

### ⚠ 警告:

- 禁止跌落、摔擊或嘗試自行維修耳機。
- 避免濕水或泡在水裡。
- 避免暴露在各種高熱環境。